

INSTALLATION PROCEDURES

ALUMINIUM DOORS



BEFORE INSTALLATION

- Check the Door Label to ensure that the door has the appropriate Performance Rating (wind / water resistance) for the installation location.
- Lift carefully from trucks. **DO NOT** use slings.
- Carry in a vertical position with sill at bottom when handling or transporting.
- Avoid knocks and abrasions.
- Stack carefully on edge to avoid damage to the finish.
- Stack in a dry place and cover to protect against paint, dust, weather, etc.

AFTER INSTALLATION

- Protect windows and doors from damage.
- **DO NOT** remove plastic wrap (if provided) until brickwork is completed. Plastic wrap should always be removed after 90 days.
- **Wash off immediately.** Remove wet cement mortar, paints, acids and other chemical spills as they occur.
- Use a soft clean sponge or cloth to clean. Avoid scratching the surfaces. **DO NOT USE** scrape tools or trowels on frames.
- Clean up when job is complete with clean water and (if required) a mild detergent. Thoroughly rinse with clean water. Ensure that the drainage slots in the frame are clean and allow maximum drainage.

- **DO NOT** distort frame by forcing it into the opening.
- Keep operating door panels closed while installing the frame.
- Windows and doors are non-load bearing. Ensure adequate clearance above head of door. Allow 10mm clearance from underside of sill to top of sill brick or tile to allow for building settlement.
- **Sill must be straight and level.** Plumb jamba in both directions. Pack frame at sill and jamba only. Frame must be square and out of twist (essential for smooth operation of panels). Check that the diagonal measurements are equal. Clearance must be maintained between sill brick or tile and door frame as detailed (see diagrams).
- Ensure that flashings are correctly fitted.
- Aluminium door frames should NOT be in direct contact with brick, concrete, concrete block work or cement rendered surfaces as this can result in severe corrosion in some circumstance.

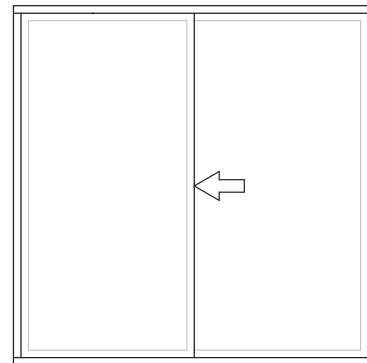

DURING INSTALLATION

- Ensure that there is sufficient clearance around the perimeter of the frame before attempting to install the door. Refer to Installation Details on right. If the wall condition is not shown refer to Dowell for the appropriate technical advice.
- Ensure the aluminium frame is insulated from contact with other metals to avoid potential future corrosion of the aluminium. This can be achieved with a bitumen coating of any steelwork around the door or application of a flashing membrane.

FRENCH DOOR INSTALLATION

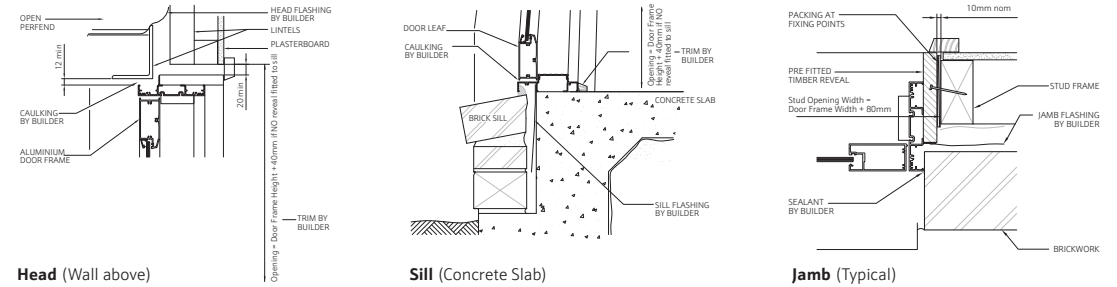

SLIDING DOOR INSTALLATION

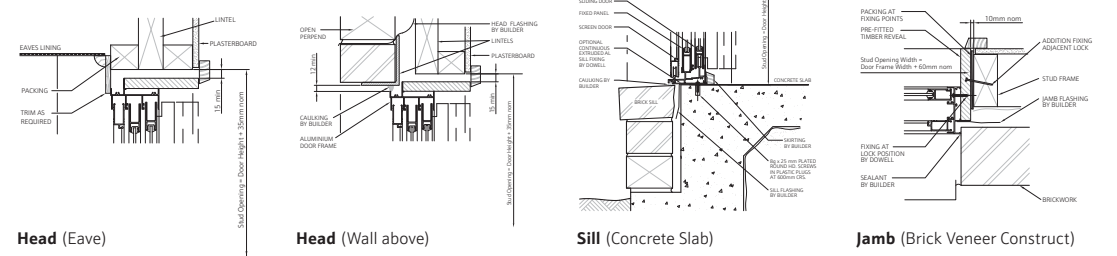

BI-FOLD DOOR INSTALLATION

